

<b>DRIVER</b>		
<b>DATE</b>		
<b>TRACK</b>		
<b>TRACTION</b>	<input type="radio"/> LOW	<input type="radio"/> MEDIUM <input type="radio"/> HIGH
<b>LAYOUT</b>	<input type="radio"/> SLOW	<input type="radio"/> MIXED <input type="radio"/> FAST
<b>TEMP °C</b>	<b>AIR</b>	<b>TRACK</b>
<b>ENGINE</b>		
TYPE	MANIFOLD	PIPE
<b>TIRES</b>		
<b>BRAND</b>		
<b>SHORE</b>	FRONT	REAR
<b>SIZE (mm)</b>		
<b>TREAT</b>		
<b>SHOCK ABSORBERS</b>		
<b>PISTON</b>	FRONT	REAR
<b>OIL</b>		
<b>SPRING</b>		
<b>ANTI ROLL BAR FRONT/REAR</b>		
<input type="radio"/> 2,0	<input type="radio"/> 2,1	<input type="radio"/> 2,2 <input type="radio"/> 2,3 <input type="radio"/> 2,4 <input type="radio"/> 2,5
<input type="radio"/> 2,0	<input type="radio"/> 2,1	<input type="radio"/> 2,2 <input type="radio"/> 2,3 <input type="radio"/> 2,4 <input type="radio"/> 2,5
<b>INSERT</b>		<b>ACKERMANN</b>
<b>T2303N(8)</b>	<input type="radio"/>	<b>T2303J(9)</b> <input type="radio"/>
<b>INSERT</b>		<b>POSITION</b>
<b>LONG</b>	<input type="radio"/> CENTER <input type="radio"/>	<b>SHORT</b> <input type="radio"/>
<b>T2303K</b>		<b>POSITION</b>
<b>LONG</b>	<input type="radio"/> CENTER <input type="radio"/>	<b>SHORT</b> <input type="radio"/>
<b>CLUTCH SETTINGS</b>		
BELL#	SHOE#	SPRING#
GAP(mm)	PLAY(mm)	PRE TENSION(mm)
<b>GEAR RATIO</b>		
<b>1<sup>st</sup> SPUR</b>	<b>52T</b>	<b>53T</b> <b>54T</b>
<b>1<sup>st</sup> PINION</b>	<b>14T</b>	<input type="radio"/> 7,61 <input type="radio"/> 7,76 <input type="radio"/> 7,91
	<b>15T</b>	<input type="radio"/> 7,11 <input type="radio"/> 7,24 <input type="radio"/> 7,38
<b>2<sup>nd</sup> SPUR</b>	<b>47T</b>	<b>48T</b> <b>49T</b>
<b>2<sup>nd</sup> PINION</b>	<b>19T</b>	<input type="radio"/> 5,07 <input type="radio"/> 5,18 <input type="radio"/> 5,28
	<b>20T</b>	<input type="radio"/> 4,82 <input type="radio"/> 4,92 <input type="radio"/> 5,02
	<b>21T</b>	<input type="radio"/> 4,59 <input type="radio"/> 4,69 <input type="radio"/> 4,78
<b>FRONT DIFF</b>	<input type="radio"/>	OIL CST.
<b>T2242 adj. oneway</b>	<input type="radio"/>	OIL CST.
<b>REAR DIFF</b>	<input type="radio"/> PLASTIC GEAR	OIL CST.

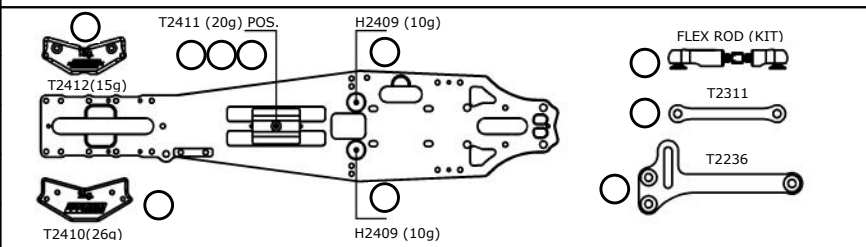
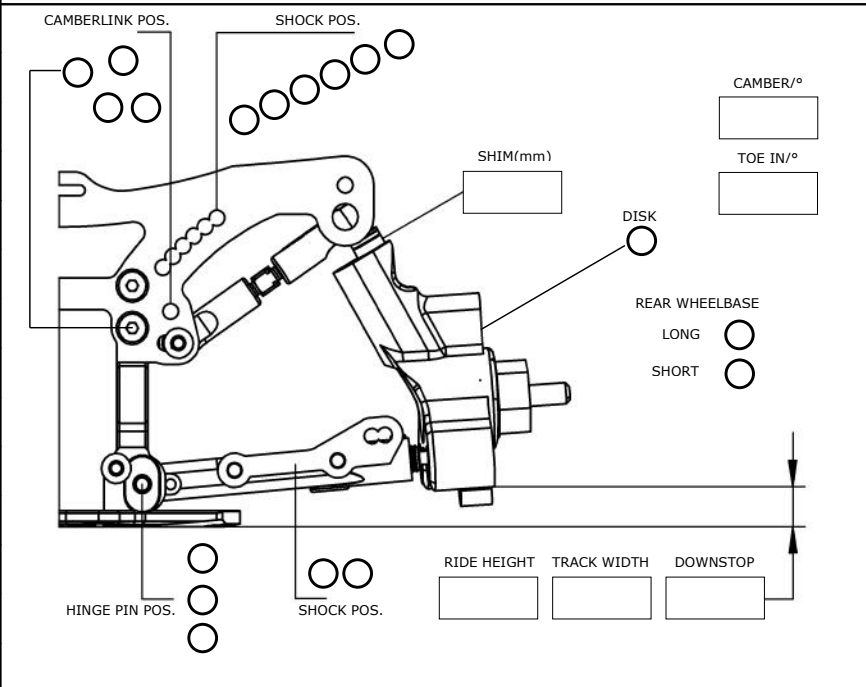
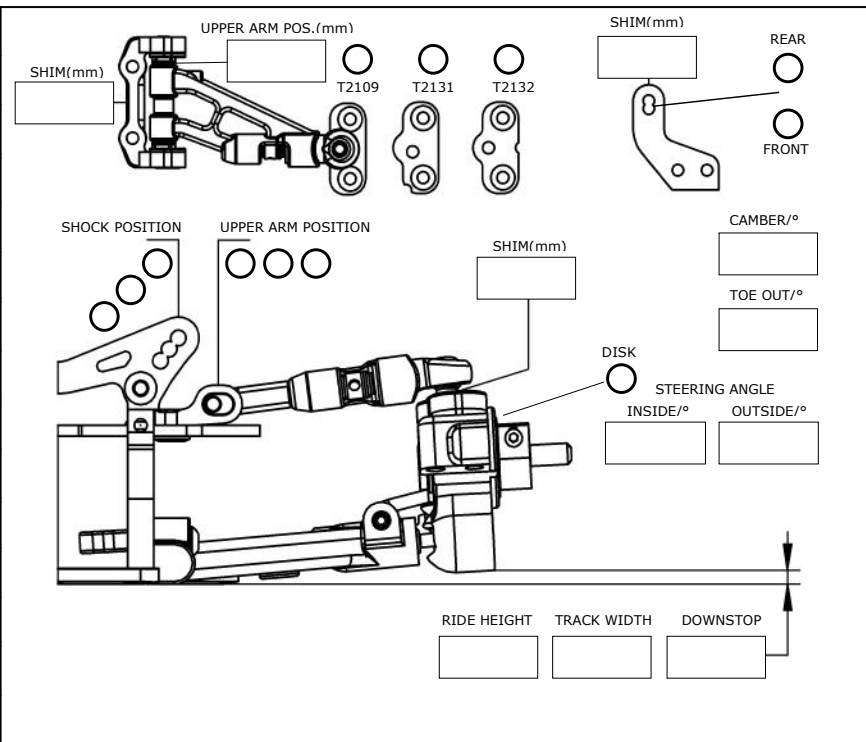

	<b>BODY TYPE</b>	
	<b>WING TYPE/OVERHANG (mm)</b>	
	<b>BODY POS. TO BUMPER (mm)</b>	

<b>REMARKS</b>	
----------------	--